

**Single Coursing**

Double the starting course at the base of the wall (Figure 6). For Number 1 Grade Certi-label Western Red Cedar shingles apply with 3mm to 6mm keyway space and for Number 1 Grade Yellow Cedar shingles, apply with 6mm to 10mm keyway space between the Certi-label shingles, giving a pronounced individual effect to each course.

Offset the side joints in any one course at least 38mm over joints in adjacent courses (Figure 2).

Use a straight edge, nailing it lightly to the wall with the edge at the butt line (to keep courses straight and level). Check for level every 3 or 4 courses.

This wall application features concealed nailing (Figure 6), with nails driven approximately 25mm above the butt line of the succeeding course. For Certi-label Western Cedar shingles up to 254mm wide, place two nails in each shingle 19mm from each edge. With Certi-label Western Cedar shingles wider than 254mm, drive two additional nails approximately 25mm apart near the center.

Because Certi-label Western Cedar shingles vary in width there should be little waste. At corners, or at door or window frames, you may have to trim a selected Certi-label Western Cedar shingle slightly.

The CSSB recommends installing over plywood panel or dimensional lumber sheathing. If other sheathing materials are approved for use by your local building official, the holding power of the fasteners should also be considered carefully.

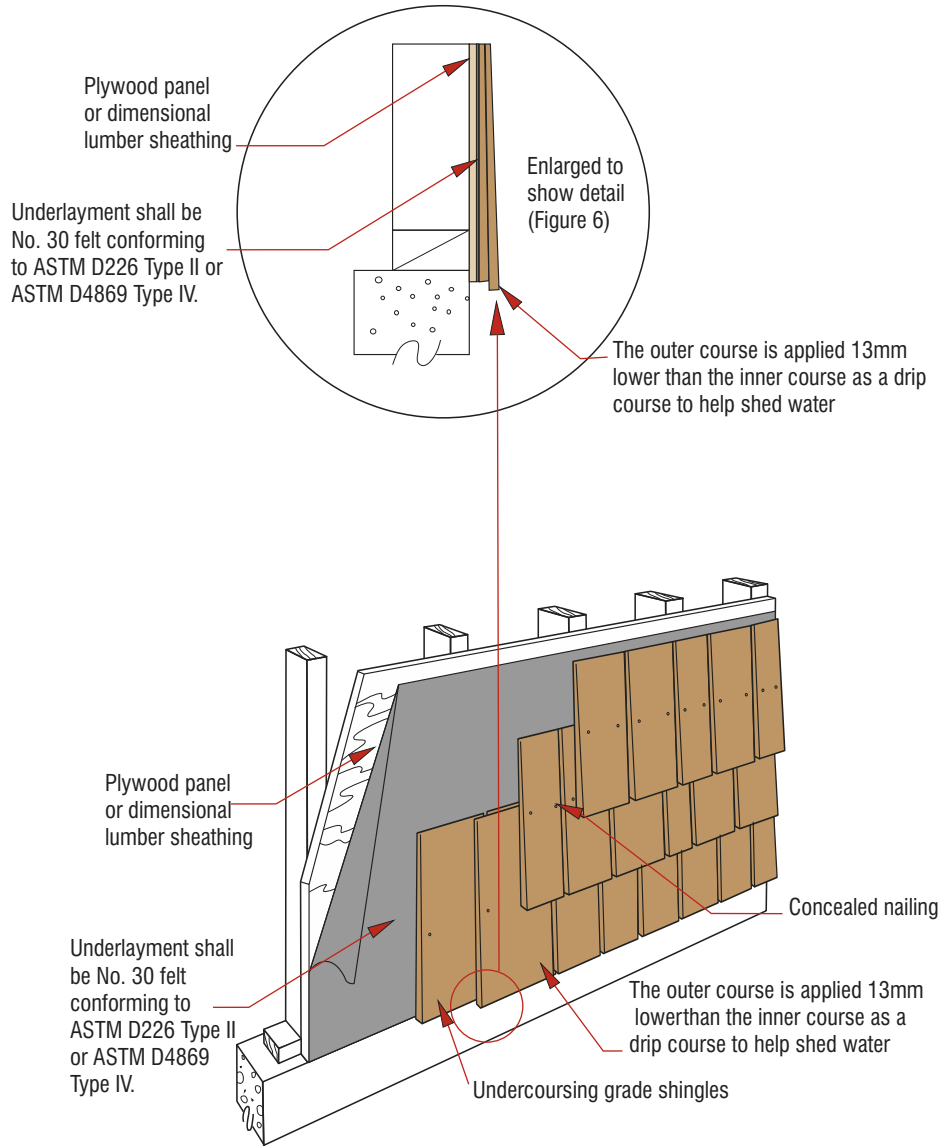

\*The Cedar Bureau recommends that underlayment shall be No. 30 felt conforming to ASTM D226 Type II or ASTM D4869 Type IV. Check with your local building official for any questions about alternative underlayment materials.

**Figure 6: Single Coursing**



Note: All figures depict shingle applications. DO NOT interlay shingles or shakes with felt on sidewall applications.